

MODELS HRSB, HRSD, HRSB-F & HRSD-F HOODED ROOF SUPPLY



6393 Powers Avenue
Jacksonville, Florida 32217-2298
P: 904.731.4711 / F: 904.737.8322
www.Jencofan.com



**Model HRSB-F Filtered Belt Drive
Model HRSD-F Filtered Direct Dive**

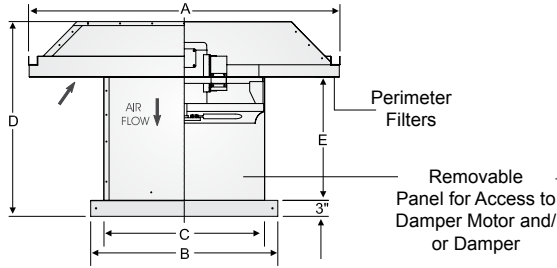

**Model HRSB Supply Belt Drive
Model HRSD Supply Direct Dive**

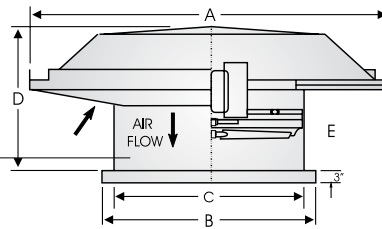

MODEL HRSB-F HRSD-F	A SQ. O.D. HOOD (2)	B I.D. CURB CAP	C MIN I.D. OPENING	D HEIGHT	E STACK	PREFAB CURB O.D.	STANDARD FILTER (7)		AVG. WT.
							SIZE (Nominal)	NO.	
24	58	35	30	31	23	33-1/4	15 x 20 x 2	8	375
24	66	35	30	31	23	33-1/4	19 x 22 x 2	8	450
30	66	41	36	32	23	39-1/4	16 x 25 x 2	8	550
30	78	41	36	32	23	39-1/4	19 x 22 x 2	12	600
36	78	47	42	34	23	45-1/4	19 x 29-3/4 x 2	8	675
36	87	47	42	34	23	45-1/4	16-1/8 x 23-1/2 x 2	16	750
42	87	53	48	43	30	51-1/4	20 x 25-1/8 x 2 / 16 x 20 x 2	8/4	850
42 (2 & 3 HP)	99	53	48	43	30	51-1/4	18-3/8 x 26-1/2 x 2	16	900
48	99	59	54	44	30	57-1/4	19-1/8 x 23-1/2 x 2	16	1100
48 (3-10 HP)	111	59	54	44	30	57-1/4	16-1/2 x 29-1/2 x 2	20	1200
54	123	65	60	46	30	63-1/4	18-1/8 x 32-1/2	20	1350
60	123	71	66	46	30	69-1/4	18-3/4 x 29-1/2	20	1600

MODEL HRSB HRSD	A SQ. O.D. HOOD (2)	B I.D. CURB CAP	C MIN I.D. OPENING	D HEIGHT	E STACK	PREFAB CURB O.D.	METAL GAUGES (1)			AVG. WT.
							CROWN/SIDE HOOD	STACK	CURB CAP	
24	58	35	30	31	23	33-1/4	18/18	18	16	425
30	66	41	36	32	23	39-1/4	18/18	18	16	550
36	78	47	42	34	23	45-1/4	18/18	18	16	700
42	87	53	48	43	30	51-1/4	18/18	16	16	800
48	99	59	54	44	30	57-1/4	18/18	16	14	1100
54	111	65	60	45	30	63-1/4	18/18	16	14	1300
60	111	71	66	46	30	69-1/4	18/18	16	14	1550

- All materials are G90 galvanized steel. All hoods are factory assembled.
- Due to shipping limitations, 87" and larger hoods will ship separate requiring field attaching. Assembled 123" hoods must ship by double drop deck flat bed truck. This will affect normal freight rates.
- Hoods will hinge and front fan panel is removable for access to fan and optional damper.
- Propellers are 2, 3, 4, or 6-bladed adjustable pitch, air-foil aluminum (Fixed pitch steel and Aluminum are also available).
- Dampers mount on accessory flanges inside curbs due to space restrictions and warranty clearance conditions.
- Delay switch required on models 5HP and larger (with motorized damper).
- Filters are 2" cleanable, aluminum and may ship separate for field installation. Specify if factory installation is required and consult factory.
- Filtered 54" fan performance is certified by Breidert Air Products.

FAN SPECIFICATIONS									MOTOR SPECIFICATIONS				
Line	Qty.	Model No.	Tag	CFM	SP	Fan RPM	BHP	Sones	HP	Volts	Phase	Hertz	Encl
1													
2													
3													

ACCESSORY ITEMS					ACCESSORY ITEMS						
	1	2	3	4	5		1	2	3	4	5
<input type="checkbox"/>						<input type="checkbox"/>					
<input type="checkbox"/>						<input type="checkbox"/>					
<input type="checkbox"/>						<input type="checkbox"/>					