

**BELT DRIVE CENTRIFUGAL UPBLAST ROOF EXHAUSTER**



**MODEL FEATURES**

- Exhaust air up to 35,000 CFM in high static pressure applications up to 3-1/4" w.g.
- Attractive spun aluminum exterior
- Belt drives permit easy performance adjustments when needed
- Non-overloading backward inclined wheel for efficiency at higher static pressures
- Roof or sidewall mounting options
- cULus 705 or 762 Listed
- NFPA - suitable for National Fire Protection Association Installations

**APPLICATION CONSTRUCTION OPTIONS**

MODEL NAME	TYPICAL APPLICATIONS
TXB	Removal of clean or contaminated air in general applications
TXBRHUL	UL762 listed for grease removal
TXBHP	High Pressure version of TXB
TXBW	Wall mount version of TXB
TXBWRHUL	UL762 version of TXBW
TXBWHP	High Pressure version of TXBW
TXBWHPRHUL	UL762 High Pressure version of TXBW

**MODEL OVERVIEW**

Model TXB belt drive fans are designed to exhaust air up to 35,000 CFM in high static pressure applications to 3-1/4". The aluminum exterior provides an attractive appearance. Belt drive results in lower operating RPM and sound levels, making the Model TXB well suited to applications where quiet operation is important. Belt drive also permits easy performance adjustments when needed to balance the total ventilation system. The non-overloading backward inclined wheel with its higher static pressure capability makes this unit suitable for either ducted or nonducted applications. It's roof or sidewall mounting options permit location near the area to be ventilated, allowing short duct runs and more efficient operation.

Isolation of motor and drive components from the airstream and the high velocity vertical air discharge make the Model TXB ideally suited for the removal of dirty contaminated and/or high temperature air from processes and buildings. Typical applications include restaurant hoods and similar kitchen exhaust ventilation, fume and smoke removal, laboratory fume hood exhaust and chemical process exhaust. The TXB line of fans is available in a variety of construction options, see the chart above for the TXB that is right for your application.

Model TXB-UL762 is available in our Quickship program. Sizes 30-36 are available for next day or 3-day shipping from stock.

**Industry best 5 year fan housing warranty, 1 year motor warranty**  
**TXBRHUL units have 2 year fan housing warranty**

## STANDARD CONSTRUCTION FEATURES AND OPTIONS

### Model TXB

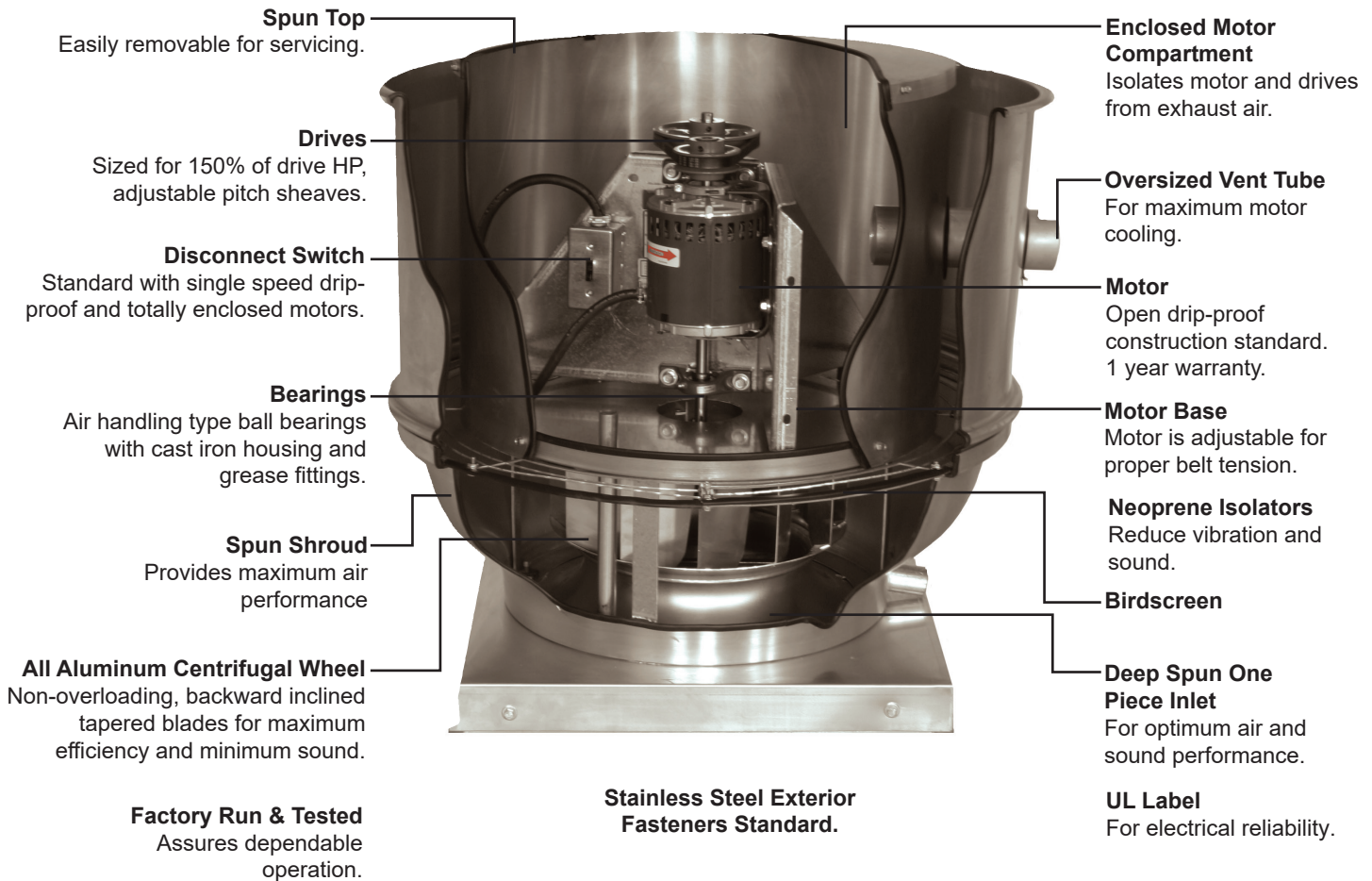

**Industry best 5 year fan housing warranty, 1 year motor warranty**



**STANDARD CONSTRUCTION FEATURES AND OPTIONS**

**Model TXB-UL762 Restaurant Exhaust**



**2 year fan housing warranty, 1 year motor warranty**



## **CONSTRUCTION/SPECIFICATION CHECKLIST**

### **Housing**

- Curb cap with integral deep single piece spun inlet for efficient performance and prevention of leakage into ductwork.
- Heavy-gauge aluminum housing and curb cap for strength and rigidity. Curb cap is galvanized steel on all UL 762 units.
- Adjustable motor base for proper belt tension and ease of adjustment.
- Enclosed ventilated motor/drive compartment isolates motor and drives from exhaust air.
- Neoprene isolators for reduction of vibration and sound.
- Quick-Release latches on motor cover for easy access to motor compartment.
- Water-tight conduit tube for easy electrical connection without having to wire through the breather tube.
- Birdscreen included on standard models (not included on UL762 units).

### **Centrifugal Wheel**

- Backward inclined for efficiency at higher static pressure.
- Non-overloading for safe operation in ducted systems.
- Heavy aluminum hub for extra strength.
- Close running tolerance between inlet cone and wheel inlet for maximum efficiency.
- Statically and dynamically balanced for smooth quiet operation.

### **Motors**

- Brands are nationally recognized and locally serviced.
- Single speed drip-proof motors are provided on standard models.
- Disconnect switch is standard with single speed open drip-proof and totally enclosed motors.
- Welded motor brackets designed for maximum strength.

### **Drives**

- Sized for minimum 150% of drive horse power.
- Machined cast iron adjustable motor pulleys.
- Adjustable base for belt tensioning.
- Nonstatic oil resistant V-Belts.

### **Bearings**

- 5 year bearing warranty.
- Heavy-duty ball bearing type.
- Prelubricated and permanently sealed.
- Sized for a minimum L50 life in excess of 200,000 hours.

### **Certifications**

- cULus 705 Listed Power Roof Ventilator label assures electrical reliability.
- UL 762 Listed for Restaurant Exhaust Appliance available for applications where required.
- cULus 705 and UL 762 assure electrical reliability for Canadian use.
- cULus label must be specified when needed.
- NFPA - Model TXB is suitable for National Fire Protection Association installations. Contact factory for required accessories.



## OPTIONS/ACCESSORIES

**Automatic Belt Tensioner:** The Automatic Belt Tensioners eliminate the need for regular manual retensioning of drives, and the risk of inadvertently over-tensioning drive components is avoided and overall drive operating efficiency is enhanced. Benefits include reduction in startup and maintenance costs, increased belt life, increased drive efficiency, and ensure drive components do not snag obstructions.

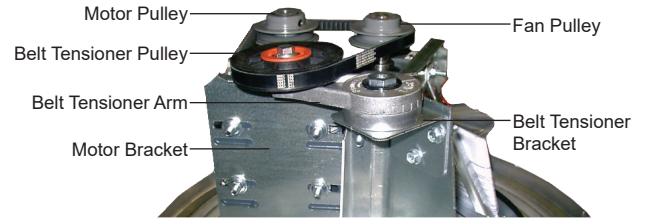

**Roof Curb:** Prefabricated heavy-gauge galvanized steel, welded construction, 12" high (other heights are also available) with 1-1/2" wood nailer. Assures perfect fit of exhauster to roof opening. Options include burglar bars, single or double pitch construction and hinged curbs for easy duct access.

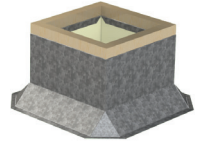

**Common Curb:** Designed to allow both the supply fan and exhaust fan to be mounted on the same curb. This curb requires only one roof opening and speeds installation time.

**Motor Operated Damper:** Motor operated aluminum damper for positive closure against backdraft. (Not for UL762 use).



**Automatic Damper:** Automatic aluminum damper for ease in installation and effective backdraft protection. (Not for UL762 use).

**Grease Grabber or Aluminum Grease Trough:** Trap designed for fast and inexpensive replacement. Grease collects in a container for safe and sanitary disposal. Keeps roof clean with proper use.

**Wall Mount Kit:** Kit allows 8-24" fans to be wall mounted. Assembled as standard on all TXDW units, not available for not wall mount units. See current submittal for details.

**Special Coatings:** Powered roof exhausters often require special coatings for protective and decorative purposes. Available coatings include: Synthetic Resin, Epoxy, and Heresite (air-dried phenolic). Contact your representative or the factory for more information on available coatings and colors.

**Curb Hinge Arrangement:** The curb hinge arrangement provides easy access to the exhaust fan, backdraft damper, and duct for servicing and cleaning.



**SIZE 30**

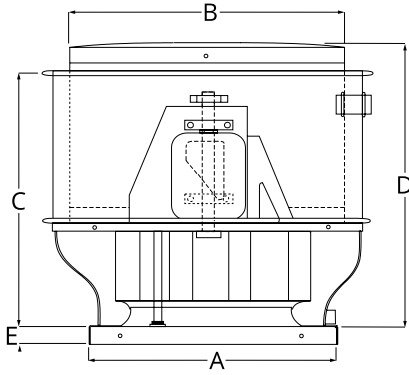

Dimensions (in.)				
A	B	C	D	E
42-1/2	56-3/4	41	45	2-1/2

Dimensional Data				Metal Thickness			Avg. Ship Wt. (lbs.)
Damper		Roof Opening	Curb OD	Curb Cap	Wind Band	Motor Cover	
ID	OD						
36	36	37-3/4	40-3/4	.090	.050	.050	365

CFM / BHP @ Static Pressure / Sones														RPM	HP	Tip Speed
1/8	1/4	3/8	1/2	5/8	3/4	1	1-1/4	1-1/2	1-3/4	2	2-1/4	Catalog Number				
3739 0.17/3.7	-	-	-	-	-	-	-	-	-	-	-	TXB-30331	280	1/3	2236	
4540 0.24/5.1	-	-	-	-	-	-	-	-	-	-	-	TXB-30332	315	1/3	2515	
5380 0.34/6.3	4233 0.33/5.4	-	-	-	-	-	-	-	-	-	-	TXB-30333	355	1/3	2835	
5682 0.39/6.8	4634 0.38/6.0	-	-	-	-	-	-	-	-	-	-	TXB-30501	370	1/2	2954	
5980 0.44/7.2	5018 0.44/6.6	3711 0.40/5.9	-	-	-	-	-	-	-	-	-	TXB-30502	385	1/2	3074	
6372 0.51/7.9	5504 0.51/7.4	4303 0.48/6.6	-	-	-	-	-	-	-	-	-	TXB-30503	405	1/2	3234	
6759 0.58/8.6	5966 0.59/8.3	4909 0.57/7.4	1661 0.32/6.9	-	-	-	-	-	-	-	-	TXB-30751	425	3/4	3394	
7141 0.67/9.4	6410 0.68/9.2	5459 0.67/8.2	4303 0.62/7.7	-	-	-	-	-	-	-	-	TXB-30752	445	3/4	3553	
7520 0.76/10.1	6840 0.78/10.0	5981 0.77/9.2	4883 0.73/8.5	-	-	-	-	-	-	-	-	TXB-30753	465	3/4	3713	
7801 0.83/10.8	7155 0.86/10.6	6355 0.85/9.9	5353 0.82/9.2	2646 0.58/8.6	-	-	-	-	-	-	-	TXB-30101	480	1	3833	
8081 0.91/11.4	7464 0.94/11.2	6717 0.94/10.6	5790 0.91/9.8	4704 0.85/9.3	-	-	-	-	-	-	-	TXB-30102	495	1	3952	
8360 1.00/12.1	7770 1.02/11.9	7067 1.03/11.4	6201 1.00/10.5	5206 0.96/10.0	-	-	-	-	-	-	-	TXB-30103	510	1	4072	
8822 1.15/13.2	8270 1.18/13.0	7631 1.19/12.8	6857 1.17/11.9	5935 1.13/11.1	4783 1.05/10.6	-	-	-	-	-	-	TXB-30151	535	1-1/2	4272	
9280 1.31/14.4	8761 1.35/14.3	8175 1.37/14.1	7478 1.36/13.2	6656 1.32/12.4	5736 1.27/11.9	-	-	-	-	-	-	TXB-30152	560	1-1/2	4471	
9736 1.49/15.6	9249 1.53/15.5	8703 1.55/15.3	8071 1.56/14.7	7326 1.53/13.8	6469 1.48/13.2	-	-	-	-	-	-	TXB-30153	585	1-1/2	4671	
10099 1.65/16.6	9634 1.69/16.4	9116 1.72/16.2	8527 1.72/15.8	7840 1.70/15.0	7056 1.66/14.3	2909 1.05/13.2	-	-	-	-	-	TXB-30201	605	2	4831	
10552 1.86/17.8	10112 1.90/17.6	9624 1.93/17.4	9080 1.95/17.2	8455 1.94/16.4	7738 1.90/15.6	6112 1.77/14.6	-	-	-	-	-	TXB-30202	630	2	5030	
10912 2.04/18.6	10491 2.09/18.4	10024 2.12/18.2	9511 2.14/18.1	8929 2.13/17.4	8264 2.11/16.6	6702 1.99/15.5	-	-	-	-	-	TXB-30203	650	2	5190	
11362 2.28/19.5	10961 2.33/19.4	10518 2.37/19.2	10039 2.39/19.1	9502 2.39/18.7	8894 2.38/18.0	7455 2.28/16.7	3010 1.40/15.8	-	-	-	-	TXB-30301	675	3	5390	
11899 2.59/20	11521 2.64/20	11105 2.69/20	10658 2.72/20	10166 2.73/20	9616 2.72/19.5	8327 2.64/18.2	6858 2.49/17.3	-	-	-	-	TXB-30302	705	3	5629	
12436 2.93/22	12077 2.99/22	11685 3.04/21	11265 3.07/21	10810 3.09/21	10309 3.09/21	9136 3.03/19	7713 2.90/18	2786 1.65/17	-	-	-	TXB-30303	735	3	5869	
13237 3.50/24	12905 3.56/24	12544 3.61/23	12156 3.66/23	11748 3.69/23	11303 3.70/23	10284 3.67/22	9079 3.57/20	7781 3.40/20	-	-	-	TXB-305001	780	5	6228	
14125 4.20/26	13818 4.27/26	13487 4.33/26	13132 4.38/26	12759 4.42/26	12364 4.45/25	11476 4.45/25	10431 4.38/23	9230 4.25/22	7946 4.04/21	-	-	TXB-305002	830	5	6627	
14922 4.92/29	14634 4.99/28	14325 5.06/28	13997 5.11/28	13649 5.16/28	13288 5.20/28	12491 5.22/27	11570 5.19/26	10516 5.08/25	9300 4.91/24	7889 4.63/23	-	TXB-305003	875	5	6987	
16070 6.09/32	15806 6.16/32	15525 6.24/32	15228 6.30/32	14914 6.36/32	14588 6.41/31	13891 6.47/31	13106 6.47/30	12215 6.41/29	11219 6.29/28	10088 6.11/27	8961 5.86/26	TXB-307501	940	7-1/2	7506	
17128 7.32/36	16882 7.40/36	16622 7.48/36	16349 7.56/35	16062 7.62/35	15762 7.68/35	15133 7.76/35	14441 7.80/34	13669 7.78/33	12806 7.70/32	11859 7.56/31	10795 7.37/30	TXB-307502	1000	7-1/2	7985	



UL STANDARD 705 for Electrical  
UL STANDARD 762 for  
Grease Removal



**SIZE 30 - HIGH PRESSURE**

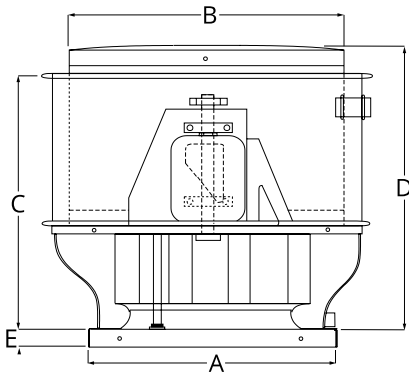

Dimensions (in.)				
A	B	C	D	E
42-1/2	56-3/4	41	45	2-1/2

Dimensional Data				Metal Thickness			Avg. Ship Wt. (lbs.)
Damper		Roof Opening	Curb OD	Curb Cap	Wind Band	Motor Cover	
ID	OD						
36	36	37-3/4	40-3/4	.090	.050	.050	365

CFM / BHP @ Static Pressure / Sones													Catalog Number	RPM	HP	Tip Speed
1/4	3/8	1/2	5/8	3/4	1	1-1/4	1-1/2	1-3/4	2	2-1/4	2-1/2					
3361 0.24/4.1	-	-	-	-	-	-	-	-	-	-	-	-	TXBHP-30332	345	1/3	2755
4404 0.35/5.4	-	-	-	-	-	-	-	-	-	-	-	-	TXBHP-30333	385	1/3	3074
4884 0.41/6.1	3604 0.38/5.5	-	-	-	-	-	-	-	-	-	-	-	TXBHP-30501	405	1/2	3234
5221 0.46/6.6	4046 0.44/6.0	-	-	-	-	-	-	-	-	-	-	-	TXBHP-30502	420	1/2	3354
5632 0.52/7.3	4589 0.52/6.7	-	-	-	-	-	-	-	-	-	-	-	TXBHP-30503	440	1/2	3513
6022 0.60/7.9	5104 0.60/7.3	3922 0.56/6.9	-	-	-	-	-	-	-	-	-	-	TXBHP-30751	460	3/4	3673
6396 0.67/8.6	5601 0.69/8.0	4529 0.65/7.6	-	-	-	-	-	-	-	-	-	-	TXBHP-30752	480	3/4	3833
6758 0.76/9.3	6073 0.78/8.7	5085 0.76/8.2	3910 0.70/7.9	-	-	-	-	-	-	-	-	-	TXBHP-30753	500	3/4	3992
7112 0.85/10.1	6512 0.87/9.5	5608 0.86/9.0	4565 0.82/8.6	-	-	-	-	-	-	-	-	-	TXBHP-30101	520	1	4152
7373 0.92/10.7	6820 0.95/10.0	5992 0.95/9.5	5016 0.91/9.2	4165 0.86/8.9	-	-	-	-	-	-	-	-	TXBHP-30102	535	1	4272
7717 1.02/11.5	7214 1.05/10.8	6486 1.06/10.3	5577 1.03/9.9	4530 0.97/9.6	-	-	-	-	-	-	-	-	TXBHP-30103	555	1	4432
8152 1.16/12.6	7687 1.19/11.9	7073 1.22/11.3	6235 1.20/10.9	5316 1.15/10.6	-	-	-	-	-	-	-	-	TXBHP-30151	580	1-1/2	4631
8582 1.31/13.7	8145 1.35/13.0	7615 1.38/12.4	6871 1.37/11.8	6028 1.34/11.5	-	-	-	-	-	-	-	-	TXBHP-30152	605	1-1/2	4831
9007 1.47/14.8	8590 1.51/14.1	8119 1.55/13.5	7479 1.56/12.9	6692 1.53/12.6	4862 1.40/12.0	-	-	-	-	-	-	-	TXBHP-30153	630	1-1/2	5030
9429 1.64/15.7	9026 1.69/15.1	8601 1.73/14.5	8056 1.75/13.9	7332 1.74/13.6	5688 1.63/13.1	-	-	-	-	-	-	-	TXBHP-30201	655	2	5230
9764 1.79/16.5	9370 1.84/15.9	8974 1.88/15.3	8484 1.91/14.7	7829 1.92/14.4	6294 1.82/13.9	-	-	-	-	-	-	-	TXBHP-30202	675	2	5390
10180 1.99/17.6	9805 2.04/17.0	9430 2.09/16.3	8991 2.13/15.8	8424 2.14/15.4	6999 2.07/14.9	-	-	-	-	-	-	-	TXBHP-30203	700	2	5589
10759 2.29/19.2	10408 2.35/18.6	10051 2.40/18.0	9667 2.44/17.5	9202 2.48/16.9	7921 2.44/16.4	6443 2.31/16.0	-	-	-	-	-	-	TXBHP-30301	735	3	5869
11252 2.57/20	10920 2.63/19.9	10572 2.69/19.3	10223 2.74/18.8	9813 2.78/18.3	8684 2.78/17.6	7335 2.68/17.2	-	-	-	-	-	-	TXBHP-30302	765	3	6108
11823 2.93/22	11511 3.00/21	11177 3.06/20	10854 3.11/20	10492 3.15/19.8	9533 3.20/19.1	8292 3.12/18.6	6897 2.97/18.2	-	-	-	-	-	TXBHP-30303	800	3	6388
12634 3.50/24	12347 3.57/23	12041 3.63/23	11729 3.69/22	11417 3.75/22	10652 3.83/21	9577 3.81/20	8371 3.70/20	6994 3.51/19	-	-	-	-	TXBHP-305001	850	5	6787
13360 4.07/26	13091 4.14/25	12807 4.21/25	12507 4.28/24	12219 4.34/24	11561 4.44/23	10672 4.48/22	9568 4.41/22	8386 4.26/21	-	-	-	-	TXBHP-305002	895	5	7146
14163 4.77/28	13912 4.85/28	13648 4.93/27	13371 5.00/27	13087 5.07/26	12514 5.18/25	11798 5.27/24	10836 5.26/24	9769 5.15/24	8617 4.98/23	7293 4.74/23	-	-	TXBHP-305003	945	5	7546
15281 5.88/32	15052 5.97/31	14812 6.06/31	14561 6.14/30	14299 6.22/30	13783 6.35/29	13205 6.46/28	12487 6.54/27	11563 6.51/27	10569 6.39/26	9514 6.22/26	8328 5.98/26	-	TXBHP-307501	1015	7-1/2	8104
16315 7.06/35	16103 7.16/35	15881 7.25/34	15651 7.34/34	15411 7.42/33	14919 7.58/32	14424 7.71/31	13840 7.82/30	13116 7.88/30	12235 7.84/29	11300 7.71/29	10319 7.53/29	-	TXBHP-307502	1080	7-1/2	8623



UL STANDARD 705 for Electrical  
UL STANDARD 762 for  
Grease Removal



**SIZE 36**

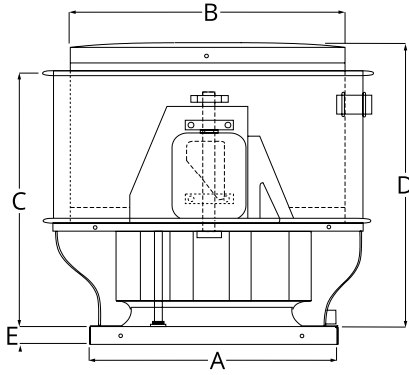

Dimensions (in.)				
A	B	C	D	E
42-1/2	66	44	48	2-1/2

Dimensional Data				Metal Thickness			Avg. Ship Wt. (lbs.)
Damper		Roof Opening	Curb OD	Curb Cap	Wind Band	Motor Cover	
ID	OD						
36	36	37-3/4	40-3/4	.090	.050	.050	365

CFM / BHP @ Static Pressure / Sones													RPM	HP	Tip Speed
0	1/8	1/4	3/8	1/2	5/8	3/4	1	1-1/4	1-1/2	1-3/4	2	Catalog Number			
7797	6629	4391	-	-	-	-	-	-	-	-	-	TXB-36501	270	1/2	2523
0.30/5.3	0.33/4.9	0.31/4.3	-	-	-	-	-	-	-	-	-	-	-	-	-
8953	8009	6496	3165	-	-	-	-	-	-	-	-	TXB-36502	310	1/2	2896
0.45/6.8	0.49/6.4	0.50/6.0	0.35/4.4	-	-	-	-	-	-	-	-	-	-	-	-
9386	8503	7139	5105	-	-	-	-	-	-	-	-	TXB-36751	325	3/4	3036
0.52/7.3	0.56/6.9	0.57/6.6	0.53/5.6	-	-	-	-	-	-	-	-	-	-	-	-
9819	8988	7771	5791	-	-	-	-	-	-	-	-	TXB-36852	340	3/4	3177
0.60/7.9	0.64/7.5	0.66/7.2	0.62/6.8	-	-	-	-	-	-	-	-	-	-	-	-
10252	9468	8369	6717	-	-	-	-	-	-	-	-	TXB-36753	355	3/4	3317
0.68/8.5	0.72/8.1	0.75/7.7	0.73/7.4	-	-	-	-	-	-	-	-	-	-	-	-
10685	9942	8940	7521	5459	-	-	-	-	-	-	-	TXB-36101	370	1	3457
0.77/9.1	0.81/8.7	0.85/8.3	0.84/8.0	0.76/6.8	-	-	-	-	-	-	-	-	-	-	-
10974	10255	9308	7971	6124	-	-	-	-	-	-	-	TXB-36102	380	1	3550
0.83/9.5	0.88/9.1	0.92/8.7	0.91/8.4	0.85/7.7	-	-	-	-	-	-	-	-	-	-	-
11407	10722	9844	8611	6793	-	-	-	-	-	-	-	TXB-36103	395	1	3690
0.93/10.2	0.98/9.8	1.02/9.4	1.03/9.0	0.97/8.7	-	-	-	-	-	-	-	-	-	-	-
11985	11339	10537	9459	8086	6251	-	-	-	-	-	-	TXB-36151	415	1-1/2	3877
1.08/11.0	1.14/10.6	1.18/10.3	1.20/9.9	1.17/9.6	1.08/8.4	-	-	-	-	-	-	-	-	-	-
12418	11799	11045	10063	8812	7081	-	-	-	-	-	-	TXB-36152	430	1-1/2	4017
1.21/11.8	1.26/11.3	1.31/10.9	1.33/10.6	1.32/10.3	1.24/9.7	-	-	-	-	-	-	-	-	-	-
12996	12410	11710	10832	9685	8075	6094	-	-	-	-	-	TXB-36153	450	1-1/2	4204
1.34/12.7	1.44/12.4	1.49/12.0	1.53/11.5	1.52/11.2	1.46/10.9	1.32/9.5	-	-	-	-	-	-	-	-	-
13285	12713	12037	11203	10113	8792	7239	-	-	-	-	-	TXB-36201	460	2	4298
1.48/13.2	1.53/12.8	1.59/12.5	1.63/12.1	1.63/11.7	1.59/11.4	1.50/10.3	-	-	-	-	-	-	-	-	-
13573	13016	12362	11566	10540	9344	7711	-	-	-	-	-	TXB-36202	470	2	4391
1.50/13.7	1.63/13.3	1.69/12.9	1.73/12.7	1.74/12.2	1.71/11.9	1.62/11.4	-	-	-	-	-	-	-	-	-
13862	13318	12685	11923	10955	9817	8152	-	-	-	-	-	TXB-36203	480	2	4484
1.68/14.2	1.74/13.8	1.79/13.4	1.84/13.0	1.86/12.8	1.83/12.4	1.74/12.2	-	-	-	-	-	-	-	-	-
14295	13770	13165	12449	11560	10483	8988	-	-	-	-	-	TXB-36204	495	2	4625
1.84/15.0	1.90/14.6	1.96/14.2	2.01/13.8	2.04/13.5	2.02/13.3	1.95/13.0	-	-	-	-	-	-	-	-	-
14873	14371	13799	13135	12334	11337	10243	-	-	-	-	-	TXB-36301	515	3	4811
2.07/15.9	2.14/15.6	2.20/15.2	2.25/14.8	2.29/14.5	2.29/14.2	2.25/14.0	-	-	-	-	-	-	-	-	-
15306	14819	14271	13640	12894	11973	10944	8299	-	-	-	-	TXB-36302	530	3	4952
2.26/16.6	2.32/16.3	2.39/16.0	2.45/15.6	2.49/15.3	2.50/15.1	2.47/14.8	2.29/13.4	-	-	-	-	-	-	-	-
15884	15416	14895	14304	13617	12788	11814	9226	-	-	-	-	TXB-36303	550	3	5138
2.52/17.7	2.59/17.3	2.66/16.9	2.72/16.6	2.77/16.4	2.79/16.2	2.78/16.0	2.61/15.5	-	-	-	-	-	-	-	-
16317	15863	15361	14795	14146	13377	12455	9936	-	-	-	-	TXB-36304	565	3	5279
2.74/18.5	2.81/18.1	2.87/17.7	2.94/17.4	2.99/17.2	3.03/17	3.02/16.8	2.87/16.3	-	-	-	-	-	-	-	-
16894	16458	15978	15443	14837	14135	13299	11336	8629	-	-	-	TXB-365001	585	5	5465
3.04/19.5	3.11/19.1	3.18/18.8	3.25/18.5	3.31/18.3	3.35/18.1	3.36/17.8	3.28/17.4	3.01/15.6	-	-	-	-	-	-	-
17472	17052	16592	16085	15516	14868	14109	12318	9875	-	-	-	TXB-365002	605	5	5652
3.36/21	3.43/20	3.51/20	3.58/20	3.64/19.0	3.69/19.0	3.72/19.0	3.67/19.0	3.45/18.0	-	-	-	-	-	-	-
18194	17792	17356	16877	16349	15756	15078	13425	11005	-	-	-	TXB-365003	630	5	5886
3.79/22	3.87/22	3.95/21	4.02/21	4.09/21	4.15/21	4.19/20	4.17/20	3.97/19.0	-	-	-	-	-	-	-
18772	18382	17963	17507	17006	16450	15824	14278	12396	10209	-	-	TXB-365004	650	5	6073
4.17/23	4.25/23	4.33/22	4.40/22	4.48/22	4.54/22	4.59/21	4.60/21	4.48/21	4.23/19	-	-	-	-	-	-
19349	18972	18568	18131	17654	17131	16548	15128	13471	11141	-	-	TXB-365005	670	5	6260
4.56/24	4.65/24	4.73/24	4.81/23	4.88/23	4.95/23	5.01/23	5.05/22	4.97/22	4.71/21	-	-	-	-	-	-
20793	20443	20074	19677	19252	18793	18292	17125	15671	14067	11871	-	TXB-367501	720	7-1/2	6727
5.66/27	5.75/27	5.84/26	5.93/26	6.01/26	6.09/26	6.16/26	6.26/25	6.24/25	6.13/24	5.83/23	-	-	-	-	-
22093	21765	21420	21055	20666	20252	19805	18797	17569	16160	14373	12478	TXB-367502	765	7-1/2	7147
6.79/30	6.89/30	6.98/29	7.07/29	7.17/29	7.25/29	7.34/28	7.47/28	7.52/27	7.46/27	7.27/26	6.97/26	-	-	-	-



UL STANDARD 705 for Electrical  
UL STANDARD 762 for  
Grease Removal





**SIZE 36 - HIGH PRESSURE**

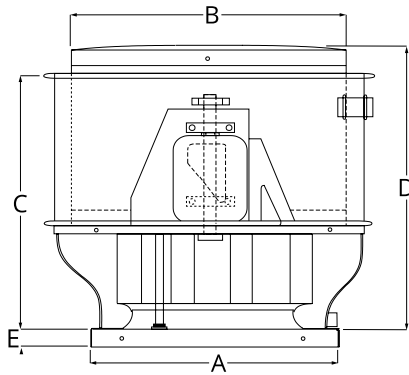

Dimensions (in.)				
A	B	C	D	E
42-1/2	66	44	48	2-1/2

Dimensional Data				Metal Thickness			Avg. Ship Wt. (lbs.)
Damper		Roof Opening	Curb OD	Curb Cap	Wind Band	Motor Cover	
ID	OD						
36	36	37-3/4	40-3/4	.090	.050	.050	365

CFM / BHP @ Static Pressure / Sones													Catalog Number	RPM	HP	Tip Speed
1/2	5/8	3/4	1	1-1/4	1-1/2	1-3/4	2	2-1/4	2-1/2	2-3/4	3					
5889 0.83/7.6	-	-	-	-	-	-	-	-	-	-	-	-	TXBHP-36101	405	1	3784
6412 0.90/7.9	-	-	-	-	-	-	-	-	-	-	-	-	TXBHP-36102	415	1	3877
7078 1.02/8.4	-	-	-	-	-	-	-	-	-	-	-	-	TXBHP-36103	430	1	4017
7862 1.17/9.2	6415 1.13/9.1	-	-	-	-	-	-	-	-	-	-	-	TXBHP-36151	450	1-1/2	4204
8575 1.33/9.9	7448 1.32/9.7	5189 1.15/10.2	-	-	-	-	-	-	-	-	-	-	TXBHP-36152	470	1-1/2	4391
9240 1.50/10.7	8286 1.51/10.5	6822 1.44/10.7	-	-	-	-	-	-	-	-	-	-	TXBHP-36153	490	1-1/2	4578
9715 1.63/11.3	8860 1.66/11.1	7692 1.62/11.2	-	-	-	-	-	-	-	-	-	-	TXBHP-36201	505	2	4718
10021 1.72/11.8	9222 1.75/11.5	8166 1.74/11.5	-	-	-	-	-	-	-	-	-	-	TXBHP-36202	515	2	4811
10467 1.86/12.5	9741 1.91/12.1	8807 1.91/12.0	-	-	-	-	-	-	-	-	-	-	TXBHP-36203	530	2	4952
10760 1.96/13.0	10075 2.01/12.6	9204 2.02/12.4	5776 1.73/13.4	-	-	-	-	-	-	-	-	-	TXBHP-36204	540	2	5045
11335 2.16/13.7	10718 2.23/13.5	9953 2.26/13.3	7428 2.11/13.9	-	-	-	-	-	-	-	-	-	TXBHP-36301	560	3	5232
11899 2.37/14.6	11330 2.45/14.3	10651 2.50/14.0	8725 2.45/14.5	-	-	-	-	-	-	-	-	-	TXBHP-36302	580	3	5419
12456 2.60/15.4	11921 2.69/15.1	11312 2.75/14.9	9665 2.76/15.0	-	-	-	-	-	-	-	-	-	TXBHP-36303	600	3	5606
13005 2.85/16.3	12499 2.94/16.0	11946 3.01/15.7	10489 3.06/15.6	7767 2.79/16.5	-	-	-	-	-	-	-	-	TXBHP-36304	620	3	5792
13684 3.18/17.4	13207 3.27/17.2	12698 3.36/16.9	11484 3.45/16.4	9572 3.36/17.2	-	-	-	-	-	-	-	-	TXBHP-365001	645	5	6026
14222 3.46/18.3	13765 3.55/18.1	13283 3.65/17.8	12188 3.77/17.3	10548 3.74/17.7	-	-	-	-	-	-	-	-	TXBHP-365002	665	5	6213
14888 3.83/19.5	14454 3.93/19.2	14000 4.03/19.0	12971 4.18/18.5	11602 4.22/19.2	9428 3.99/20	-	-	-	-	-	-	-	TXBHP-365003	690	5	6446
15417 4.15/20	14998 4.25/20	14564 4.36/19.9	13608 4.53/19.4	12374 4.6/19.1	10667 4.5/19.8	-	-	-	-	-	-	-	TXBHP-365004	710	5	6633
16074 4.57/22	15673 4.68/21	15259 4.79/21	14372 4.98/21	13277 5.10/20	11884 5.07/21	9319 4.67/21	-	-	-	-	-	-	TXBHP-365005	735	5	6867
17506 5.60/24	17136 5.72/24	16761 5.84/24	15974 6.06/23	15095 6.25/23	14005 6.34/22	12622 6.29/23	10338 5.88/24	-	-	-	-	-	TXBHP-367501	790	7-1/2	7381
18794 6.66/26	18449 6.79/26	18099 6.92/26	17379 7.16/26	16608 7.39/25	15721 7.56/25	14638 7.62/25	13290 7.54/25	11142 7.12/26	-	-	-	-	TXBHP-367502	840	7-1/2	7848
19817 7.61/28	19488 7.74/28	19157 7.87/28	18479 8.14/28	17767 8.39/27	16993 8.61/27	16067 8.73/26	14959 8.75/27	13585 8.63/27	11274 8.06/28	-	-	-	TXBHP-361001	880	10	8222
20834 8.64/31	20520 8.78/30	20205 8.92/30	19563 9.20/30	18897 9.47/30	18188 9.71/29	17392 9.90/29	16453 9.99/29	15337 9.99/29	11556 9.13/29	8370 7.79/30	-	-	TXBHP-361002	920	10	8595



UL STANDARD 705 for Electrical  
UL STANDARD 762 for  
Grease Removal



MODEL TXB

BELT DRIVE CENTRIFUGAL UPBLAST ROOF EXHAUSTER

JencoFan

SIZE 42

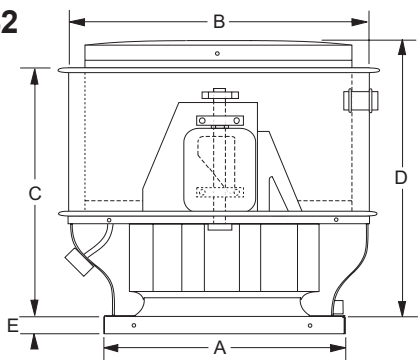

Dimensions (in.)				
A	B	C	D	E
55	72-1/2	48	52	2-1/2

Dimensional Data				Metal Thickness			Avg. Ship Wt. (lbs.)
Damper		Roof Opening	Curb OD	Curb Cap	Wind Band	Motor Cover	
ID	OD						
48	48	50-1/4	53-1/4	.100	.050	.050	385

CFM / BHP @ Static Pressure / Sones													RPM	HP	Tip Speed
0	1/8	1/4	3/8	1/2	5/8	3/4	1	1-1/4	1-1/2	1-3/4	2	Catalog Number			
10306	7988	-	-	-	-	-	-	-	-	-	-	TXB-42501	200	1/2	2199
0.28/6.8	0.33/6.8	-	-	-	-	-	-	-	-	-	-	-	-	-	-
11852	10011	6471	-	-	-	-	-	-	-	-	-	TXB-42502	230	1/2	2829
0.43/8.2	0.49/8.2	0.45/8.2	-	-	-	-	-	-	-	-	-	-	-	-	-
12625	10926	7540	-	-	-	-	-	-	-	-	-	TXB-42751	245	3/4	2694
0.52/9.0	0.59/8.9	0.57/8.8	-	-	-	-	-	-	-	-	-	-	-	-	-
13656	12109	9589	-	-	-	-	-	-	-	-	-	TXB-42752	265	3/4	2914
0.66/10.0	0.74/9.9	0.76/9.8	-	-	-	-	-	-	-	-	-	-	-	-	-
14429	12977	11065	7791	-	-	-	-	-	-	-	-	TXB-42101	280	1	3079
0.78/10.8	0.86/10.6	0.91/10.5	0.81/10.4	-	-	-	-	-	-	-	-	-	-	-	-
14944	13549	11868	8543	-	-	-	-	-	-	-	-	TXB-42102	290	1	3189
0.86/11.4	0.95/11.2	1.01/11.0	0.93/10.8	-	-	-	-	-	-	-	-	-	-	-	-
15459	14116	12546	9230	-	-	-	-	-	-	-	-	TXB-42151	300	1-1/2	3299
0.96/11.9	1.05/11.8	1.11/11.6	1.04/11.4	-	-	-	-	-	-	-	-	-	-	-	-
16232	14959	13514	10696	8017	-	-	-	-	-	-	-	TXB-42152	315	1-1/2	3464
1.11/12.6	1.20/12.4	1.28/12.3	1.26/12.2	1.12/12.0	-	-	-	-	-	-	-	-	-	-	-
17005	15795	14449	12322	9513	-	-	-	-	-	-	-	TXB-42153	330	1-1/2	3628
1.27/13.4	1.37/13.3	1.46/13.1	1.49/13.0	1.35/12.8	-	-	-	-	-	-	-	-	-	-	-
17521	16349	15060	13278	10223	6983	-	-	-	-	-	-	TXB-42201	340	2	3738
1.39/14.0	1.50/13.8	1.58/13.7	1.63/13.5	1.50/13.3	1.22/13.0	-	-	-	-	-	-	-	-	-	-
18294	17174	15960	14521	11441	9452	-	-	-	-	-	-	TXB-42202	355	2	3903
1.59/14.9	1.69/14.7	1.79/14.6	1.86/14.4	1.76/14.1	1.92/13.8	-	-	-	-	-	-	-	-	-	-
18809	17772	16553	15207	12488	10337	6123	-	-	-	-	-	TXB-42203	365	2	4013
1.72/15.4	1.83/15.3	1.93/15.1	2.01/15.0	1.96/14.8	1.81/14.3	1.39/14.0	-	-	-	-	-	-	-	-	-
19582	18540	17430	16182	14122	11420	8695	-	-	-	-	-	TXB-42301	380	3	4178
1.95/16.3	2.06/16.1	2.17/15.9	2.25/15.8	2.27/15.6	2.10/15.2	1.85/14.8	-	-	-	-	-	-	-	-	-
20355	19354	18296	17129	15546	12609	10936	-	-	-	-	-	TXB-42302	395	3	4343
2.18/17.2	2.31/17.0	2.42/16.8	2.51/16.6	2.56/16.5	2.42/16.2	2.27/15.7	-	-	-	-	-	-	-	-	-
21128	20165	19154	18055	16774	14170	12073	-	-	-	-	-	TXB-42303	410	3	4508
2.44/18.0	2.57/17.8	2.68/17.7	2.79/17.5	2.86/17.3	2.79/17.1	2.61/16.6	-	-	-	-	-	-	-	-	-
21643	20705	19722	18661	17462	15269	12766	6656	-	-	-	-	TXB-425001	420	5	4618
2.63/18.6	2.75/18.4	2.87/18.2	2.98/18.1	3.07/17.9	3.04/17.7	2.85/17.3	2.09/16.4	-	-	-	-	-	-	-	-
22159	21243	20286	19262	18119	16303	13562	8822	-	-	-	-	TXB-425002	430	5	4728
2.82/19.3	2.95/19.1	3.07/18.9	3.18/18.7	3.28/18.5	3.29/1.83	3.11/18.0	2.47/17.0	-	-	-	-	-	-	-	-
22931	22048	21129	20153	19082	17681	15074	11238	-	-	-	-	TXB-425003	445	5	4893
3.12/20	3.26/20	3.39/19.8	3.51/19.6	3.61/19.4	3.67/19.3	3.54/19.0	3.14/18.0	-	-	-	-	-	-	-	-
23447	22538	21687	20740	19710	18484	16173	12535	-	-	-	-	TXB-425004	455	5	5003
3.34/21	3.48/21	3.61/20	3.73/20	3.84/20	3.91/19.9	3.85/19.7	3.47/18.6	-	-	-	-	-	-	-	-
24220	23384	22521	21614	20638	19551	17756	13694	-	-	-	-	TXB-425005	470	5	5168
3.68/22	3.83/22	3.96/21	4.09/21	4.20/21	4.29/21	4.3/21	3.92/19.7	-	-	-	-	-	-	-	-
24735	23917	23074	22181	21247	20208	18703	14400	9783	-	-	-	TXB-425006	480	5	5278
3.92/22	4.07/22	4.21/22	4.34/22	4.46/22	4.56/21	4.60/21	4.23/20	3.41/19.0	-	-	-	-	-	-	-
25508	24176	23901	23052	22152	21173	19975	15519	12017	-	-	-	TXB-425007	495	5	5443
4.30/23	4.45/23	4.60/23	4.74/23	4.86/23	4.97/22	5.04/22	4.73/22	4.24/20	-	-	-	-	-	-	-
26539	25778	24997	24188	23339	22429	21427	17525	14525	-	-	-	TXB-427501	515	7-1/2	5663
4.84/25	5.00/25	5.15/24	5.30/24	5.43/24	5.55/24	5.65/24	5.50/23	5.08/22	-	-	-	-	-	-	-
27312	26573	25817	25035	24218	23351	22410	19179	15634	11323	-	-	TXB-427502	530	7-1/2	5828
5.28/26	5.44/25	5.60/25	5.75/25	5.89/25	6.02/25	6.13/25	6.11/24	5.65/23	4.74/22	-	-	-	-	-	-
28342	27631	26904	26152	25378	24561	23684	21215	17031	14648	-	-	TXB-427503	530	7-1/2	6047
5.90/27	6.07/27	6.23/26	6.39/26	6.54/26	6.68/26	6.80/26	6.91/25	6.45/24	6.04/24	-	-	-	-	-	-
29115	28423	27717	26992	26241	25455	24621	22538	18467	15978	11004	-	TXB-427504	565	7-1/2	6212
6.39/28	6.57/28	6.74/27	6.90/27	7.06/27	7.20/27	7.33/27	7.50/26	7.15/26	6.72/25	5.45/24	-	-	-	-	-



UL STANDARD 705 for Electrical  
UL STANDARD 762 for  
Grease Removal



**SIZE 48**

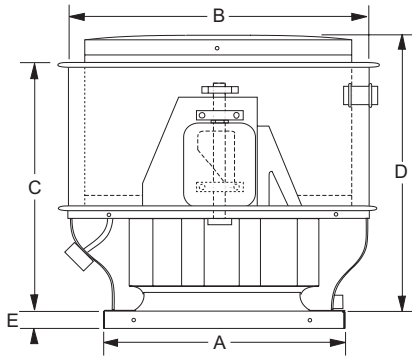

Dimensions (in.)				
A	B	C	D	E
55	78-3/4	52	55	2-1/2

Dimensional Data				Metal Thickness			Avg. Ship Wt. (lbs.)
Damper		Roof Opening	Curb OD	Curb Cap	Wind Band	Motor Cover	
ID	OD						
48	48	50-1/4	53-1/4	.100	.050	.050	490

CFM / BHP @ Static Pressure / Sones													RPM	HP	Tip Speed	
0	1/8	1/4	3/8	1/2	5/8	3/4	1	1-1/4	1-1/2	1-3/4	2	Catalog Number				
11713	8527	-	-	-	-	-	-	-	-	-	-	TXB-48501	170	1/2	2114	
0.33/3.5	0.37/3.1	-	-	-	-	-	-	-	-	-	-	-	TXB-48502	180	1/2	2238
12402	9664	-	-	-	-	-	-	-	-	-	-	TXB-48503	190	1/2	2363	
0.39/3.9	0.44/3.6	-	-	-	-	-	-	-	-	-	-	-	TXB-48751	205	3/4	2549
13091	10066	-	-	-	-	-	-	-	-	-	-	-	TXB-48752	215	3/4	2674
0.46/4.3	0.52/4.0	-	-	-	-	-	-	-	-	-	-	-	TXB-48101	230	1	2860
13091	10666	-	-	-	-	-	-	-	-	-	-	-	TXB-48102	240	1	2984
0.46/4.3	0.52/4.7	-	-	-	-	-	-	-	-	-	-	-	TXB-48151	250	1-1/2	3109
14813	12737	8924	-	-	-	-	-	-	-	-	-	-	TXB-48152	260	1-1/2	3233
0.67/5.4	0.75/5.2	0.70/5.2	-	-	-	-	-	-	-	-	-	-	TXB-48153	270	1-1/2	3358
15847	13896	10899	-	-	-	-	-	-	-	-	-	-	TXB-48201	285	2	3544
0.82/6.1	0.91/5.9	0.90/5.6	-	-	-	-	-	-	-	-	-	-	TXB-48202	300	2	3731
16536	14656	12014	-	-	-	-	-	-	-	-	-	-	TXB-48301	310	3	3855
0.93/6.0	1.02/6.3	1.04/6.1	-	-	-	-	-	-	-	-	-	-	TXB-48302	320	3	3979
17225	15408	13163	-	-	-	-	-	-	-	-	-	-	TXB-48303	330	3	4104
1.05/7.0	1.15/6.7	1.19/6.5	-	-	-	-	-	-	-	-	-	-	TXB-48304	340	3	4228
17914	16154	14236	10299	-	-	-	-	-	-	-	-	-	TXB-485001	355	5	4415
1.18/7.4	1.29/7.2	1.34/7.0	1.22/7.0	-	-	-	-	-	-	-	-	-	TXB-485002	375	5	4663
18603	16895	15206	11919	-	-	-	-	-	-	-	-	-	TXB-485003	390	5	4850
1.32/7.9	1.44/7.6	1.50/7.4	1.41/7.3	-	-	-	-	-	-	-	-	-	TXB-485004	405	5	5036
19636	17999	16495	13726	9349	-	-	-	-	-	-	-	-	TXB-487501	425	7-1/2	5285
1.56/8.5	1.68/8.3	1.75/8.1	1.72/7.9	1.48/8.3	-	-	-	-	-	-	-	-	TXB-487502	440	7-1/2	5471
20670	19097	17694	15399	11849	-	-	-	-	-	-	-	-	TXB-487503	460	7-1/2	5720
1.87/9.2	1.95/9.0	2.03/8.8	2.04/8.5	1.87/8.6	-	-	-	-	-	-	-	-	TXB-481001	480	10	5969
21359	19825	18476	16546	13528	8885	-	-	-	-	-	-	-	TXB-481002	495	10	6155
2.00/9.8	2.14/9.5	2.23/9.3	2.26/9.1	2.12/9.0	1.77/9.9	-	-	-	-	-	-	-	TXB-481003	510	10	6342
22048	20551	19249	17592	14793	10661	-	-	-	-	-	-	-	-	-	-	-
2.20/10.3	2.35/10.1	2.44/9.8	2.49/9.6	2.39/9.5	2.11/10.0	-	-	-	-	-	-	-	-	-	-	-
22737	21275	20013	18560	15952	12193	-	-	-	-	-	-	-	-	-	-	-
2.42/10.8	2.57/10.6	2.67/10.4	2.73/10.2	2.67/10.0	2.44/10.3	-	-	-	-	-	-	-	-	-	-	-
23426	21997	20771	19458	17054	14121	9830	-	-	-	-	-	-	-	-	-	-
2.64/11.5	2.80/11.2	2.91/11.0	2.98/10.8	2.95/10.6	2.76/10.7	2.34/10.7	-	-	-	-	-	-	-	-	-	-
24459	23071	21898	20682	18779	16204	12357	-	-	-	-	-	-	-	-	-	-
3.01/12.4	3.18/12.1	3.29/11.8	3.38/11.6	3.40/11.5	3.25/11.4	2.95/12.0	-	-	-	-	-	-	-	-	-	-
25837	24513	23387	22266	20855	18507	15915	-	-	-	-	-	-	-	-	-	-
3.55/13.8	3.73/13.5	3.86/13.3	3.95/13.1	4.01/13.0	3.94/12.9	3.72/13.0	-	-	-	-	-	-	-	-	-	-
26871	25587	24495	23428	22250	20201	17886	10701	-	-	-	-	-	-	-	-	-
3.99/14.8	4.18/14.6	4.32/14.5	4.42/14.3	4.50/14.2	4.49/14.1	4.31/14.1	3.44/15.0	-	-	-	-	-	-	-	-	-
27904	26658	25598	24574	23485	21877	19631	13520	-	-	-	-	-	-	-	-	-
4.47/15.8	4.67/15.7	4.82/15.5	4.93/15.4	5.02/15.4	5.05/15.4	4.94/15.5	4.28/15.6	-	-	-	-	-	-	-	-	-
29282	28083	27061	26086	25081	23863	21866	16901	8340	-	-	-	-	-	-	-	-
5.16/17.3	5.38/17.2	5.54/17.1	5.66/17.1	5.77/17.0	5.84/17.1	5.84/17.0	5.33/17.0	3.81/17.8	-	-	-	-	-	-	-	-
30316	29150	28153	27209	26253	25207	23573	19343	12941	-	-	-	-	-	-	-	-
5.73/18.5	5.95/18.4	6.12/18.3	6.26/18.3	6.37/18.1	6.46/18	6.48/17.8	6.09/17.7	5.12/18.4	-	-	-	-	-	-	-	-
31694	30569	29604	29697	27792	26837	25611	21797	16210	-	-	-	-	-	-	-	-
6.55/19.9	6.78/19.8	6.96/19.6	7.12/19.4	7.24/19.3	7.3/19.1	7.40/19.0	7.17/18.7	6.47/19.2	-	-	-	-	-	-	-	-
33072	31984	31049	30174	29311	28422	27448	24028	19817	13705	-	-	-	-	-	-	-
7.44/21	7.69/21	7.88/21	8.05/21	8.18/21	8.30/20	8.39/20	8.31/19.9	7.75/20	6.55/20.9	-	-	-	-	-	-	-
34105	33045	32130	31276	30441	29589	28681	25750	22031	16402	-	-	-	-	-	-	-
8.16/22	8.42/22	8.62/22	8.79/22	8.94/21	9.07/21	9.17/21	9.19/21	8.72/21	7.79/21	-	-	-	-	-	-	-
35139	34105	33209	32375	31563	30747	29887	27429	23870	18697	12370	-	-	-	-	-	-
8.92/23	9.19/23	9.40/23	9.59/23	9.74/22	9.88/22	9.99/22	10.09/22	9.73/21	8.99/22	7.27/23	-	-	-	-	-	-



UL STANDARD 705 for Electrical  
UL STANDARD 762 for  
Grease Removal