

MODELS HRSB, HRSD, HRSB-F & HRSD-F HOODED ROOF SUPPLY

JencoFan

6393 Powers Avenue
Jacksonville, Florida 32217-2298
P: 904.731.4711 / F: 904.737.8322
www.Jencofan.com

Soler&Palau
Ventilation Group



**Model HRSB-F Filtered Belt Drive
Model HRSD-F Filtered Direct Dive**

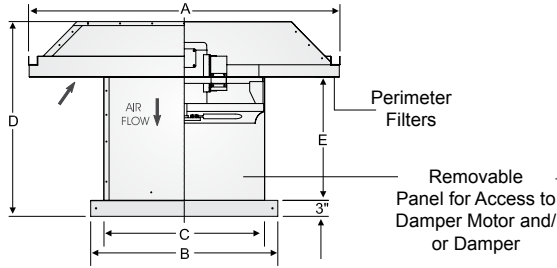

**Model HRSB Supply Belt Drive
Model HRSD Supply Direct Dive**

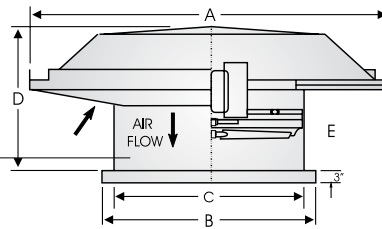

| MODEL HRSB-F HRSD-F | A SQ. O.D. HOOD (2) | B I.D. CURB CAP | C MIN I.D. OPENING | D HEIGHT | E STACK | PREFAB CURB O.D. | STANDARD FILTER (7) | | AVG. WT. |
|---------------------------|---------------------------|-----------------------|--------------------------|-------------|------------|---------------------|----------------------------------|-----|-------------|
| | | | | | | | SIZE (Nominal) | NO. | |
| 24 | 58 | 35 | 30 | 31 | 23 | 33-1/4 | 15 x 20 x 2 | 8 | 375 |
| 24 | 66 | 35 | 30 | 31 | 23 | 33-1/4 | 19 x 22 x 2 | 8 | 450 |
| 30 | 66 | 41 | 36 | 32 | 23 | 39-1/4 | 16 x 25 x 2 | 8 | 550 |
| 30 | 78 | 41 | 36 | 32 | 23 | 39-1/4 | 19 x 22 x 2 | 12 | 600 |
| 36 | 78 | 47 | 42 | 34 | 23 | 45-1/4 | 19 x 29-3/4 x 2 | 8 | 675 |
| 36 | 87 | 47 | 42 | 34 | 23 | 45-1/4 | 16-1/8 x 23-1/2 x 2 | 16 | 750 |
| 42 | 87 | 53 | 48 | 43 | 30 | 51-1/4 | 20 x 25-1/8 x 2 / 16 x 20 x 2 | 8/4 | 850 |
| 42 (2 & 3 HP) | 99 | 53 | 48 | 43 | 30 | 51-1/4 | 18-3/8 x 26-1/2 x 2 | 16 | 900 |
| 48 | 99 | 59 | 54 | 44 | 30 | 57-1/4 | 19-1/8 x 23-1/2 x 2 | 16 | 1100 |
| 48 (3-10 HP) | 111 | 59 | 54 | 44 | 30 | 57-1/4 | 16-1/2 x 29-1/2 x 2 | 20 | 1200 |
| 54 | 123 | 65 | 60 | 46 | 30 | 63-1/4 | 18-1/8 x 32-1/2 | 20 | 1350 |
| 60 | 123 | 71 | 66 | 46 | 30 | 69-1/4 | 18-3/4 x 29-1/2 | 20 | 1600 |

| MODEL HRSB HRSD | A SQ. O.D. HOOD (2) | B I.D. CURB CAP | C MIN I.D. OPENING | D HEIGHT | E STACK | PREFAB CURB O.D. | METAL GAUGES (1) | | | AVG. WT. |
|-----------------------|---------------------------|-----------------------|--------------------------|-------------|------------|---------------------|--------------------|-------|-------------|-------------|
| | | | | | | | CROWN/SIDE HOOD | STACK | CURB CAP | |
| 24 | 58 | 35 | 30 | 31 | 23 | 33-1/4 | 18/18 | 18 | 16 | 425 |
| 30 | 66 | 41 | 36 | 32 | 23 | 39-1/4 | 18/18 | 18 | 16 | 550 |
| 36 | 78 | 47 | 42 | 34 | 23 | 45-1/4 | 18/18 | 18 | 16 | 700 |
| 42 | 87 | 53 | 48 | 43 | 30 | 51-1/4 | 18/18 | 16 | 16 | 800 |
| 48 | 99 | 59 | 54 | 44 | 30 | 57-1/4 | 18/18 | 16 | 14 | 1100 |
| 54 | 111 | 65 | 60 | 45 | 30 | 63-1/4 | 18/18 | 16 | 14 | 1300 |
| 60 | 111 | 71 | 66 | 46 | 30 | 69-1/4 | 18/18 | 16 | 14 | 1550 |

- All materials are G90 galvanized steel. All hoods are factory assembled.
- Due to shipping limitations, 87" and larger hoods will ship separate requiring field attaching. Assembled 123" hoods must ship by double drop deck flat bed truck. This will affect normal freight rates.
- Hoods will hinge and front fan panel is removable for access to fan and optional damper.
- Propellers are 2, 3, 4, or 6-bladed adjustable pitch, air-foil aluminum (Fixed pitch steel and Aluminum are also available).
- Dampers mount on accessory flanges inside curbs due to space restrictions and warranty clearance conditions.
- Delay switch required on models 5HP and larger (with motorized damper).
- Filters are 2" cleanable, aluminum and may ship separate for field installation. Specify if factory installation is required and consult factory.
- Filtered 54" fan performance is certified by Breidert Air Products.

| FAN SPECIFICATIONS | | | | | | | | | MOTOR SPECIFICATIONS | | | | |
|--------------------|------|-----------|-----|-----|----|---------|-----|-------|----------------------|-------|-------|-------|------|
| Line | Qty. | Model No. | Tag | CFM | SP | Fan RPM | BHP | Sones | HP | Volts | Phase | Hertz | Encl |
| 1 | | | | | | | | | | | | | |
| 2 | | | | | | | | | | | | | |
| 3 | | | | | | | | | | | | | |

| ACCESSORY ITEMS | | | | | ACCESSORY ITEMS | | | | | | |
|--------------------------|---|---|---|---|-----------------|--------------------------|---|---|---|---|---|
| | 1 | 2 | 3 | 4 | 5 | | 1 | 2 | 3 | 4 | 5 |
| <input type="checkbox"/> | | | | | | <input type="checkbox"/> | | | | | |
| <input type="checkbox"/> | | | | | | <input type="checkbox"/> | | | | | |
| <input type="checkbox"/> | | | | | | <input type="checkbox"/> | | | | | |